



Video Tracker





ZX-*GZ4-CV3*

User Manual

Notes

- In order to ensure the instruments are in good technical condition, the daily maintenance of the operating personnel is only limited to the replacement and inspection of cables, cleaning and functional inspection.
- Please do not open the cabinet in any case even if the system runs into malfunction. Troubleshooting has to be taken on by professional technicians after thorough examinations.
- The video tracker should be kept in a cool, dry environment for storage.
- Please make sure that the connector assemblies were inserted after aligned with sockets. Please do not pull the cable directly for unplugging.
- Wearing anti-static gloves when using and connecting the product to prevent it from being penetrated.
- The power input voltage of the video tracker should be 12V, otherwise the device would be damaged.

Package List

Video tracker×1	6pin (TTL) testing cable×1
	
Ethernet cable×1	30pin cable×1
	
 <p>Note: To prevent the equipment from being damaged, please connect it to the power in the last step. Please note the insertion pin.</p>	

Parameters

Video format	Input video	LVDS (Sony HD coaxial 30pin)
	Output video	HD 1080P
	Video storage	SD card storage JPEG image/H.264 video
Tracking index	Data refresh rate	25Hz-60Hz
	Output lag	<500ms
	Minimum target contrast	5%
	Tracking velocity	± 32 pixels / frame
	Target effective memory	100 frame
	Target size	16×16~128×128 pixels
Electrical interface	Video interface	30pin (input) / SDI+Ethernet (output)
	Communication interface	RS232/TTL
	Power input	12V
Environmental adaptation	Working temperature	-40℃~60℃
	Storage temperature	-45℃~65℃
	Shock	Meet the GJB 150A vibration test conditions
	Strike	Meet the GJB 150A impact test conditions
Others	Volume	38mm×38mm×21mm
	Weight	<32g
	Power consumption	≤3W (@25℃)

Connections

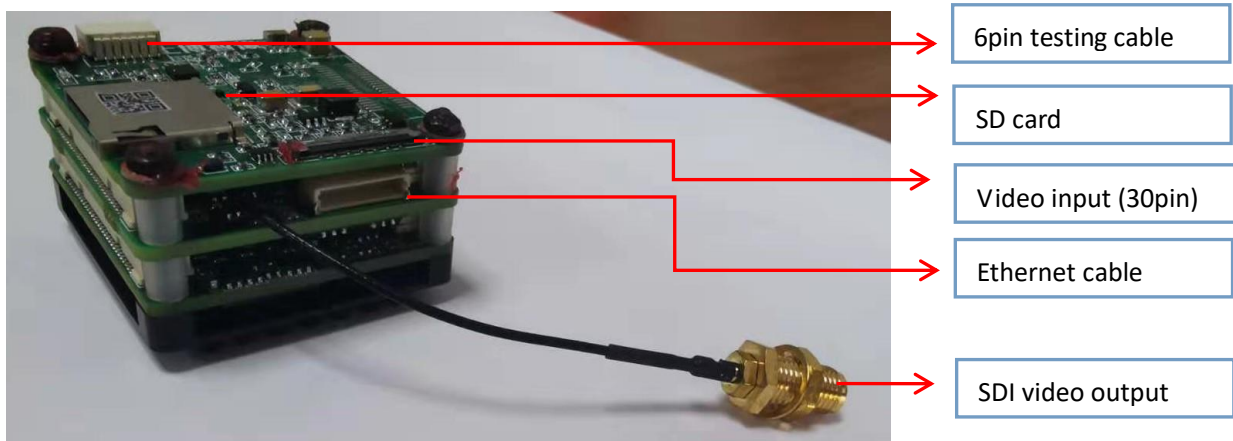

***Note: Please do NOT insert the upgrading interface (7pin)**

Troubleshoot

Please use the form below to check the IPM when it has any trouble. Disconnect the power and contact our technical team if problem remains.

Malfunction	Reason and solution
IPM cannot start/Power light is not on	1. Check whether the power is connected. 2. Check whether the voltage is lower than required which should be 12V.
No image display	1. Check whether the serial port is open(not serial port 1) 2. Check whether the baud rate setting of the operation software is correct. 3. Check whether the video output format of the displayer is 1080P.
The serial command does not respond	1. Check whether the serial port is open (not serial port 1 open) Check whether the verification mode is correct.
No tracking box	1. The target is too close or not obvious, reselect target.

Dimensions

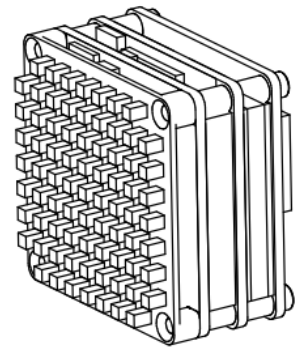
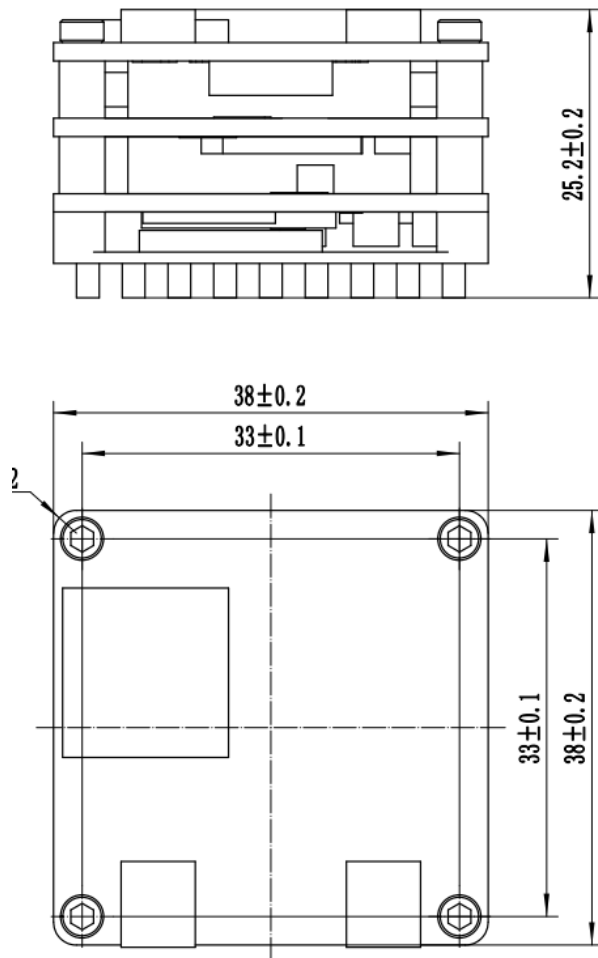

Pin Definition

6 pin interface

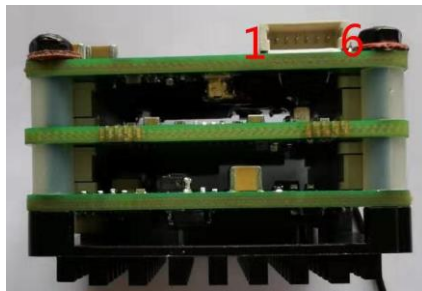

30 pin interface

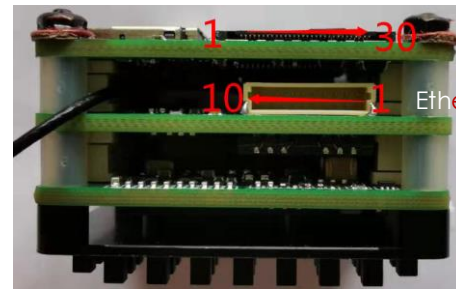

Pin #	Pin title	Function
1	POWER IN	+12V power in
2	POWER IN	+12V power out
3	GND	GND
4	GND	GND
5	RXD	Serial port receive
6	TXD	Serial port send

Ethernet pin definition		
Pin #	Pin title	Function
1	DATA_1_N	TX_N
2	DATA_1_P	TX_P
3	DATA_0_N	RX_N
4	DATA_0_P	RX_P

30pin definition	
Pin #	Pin title
1	TXOUT3+
2	TXOUT3-
3	TXCLKOUT+
4	TXCLKOUT-
5	TXOUT2+
6	TXOUT2-
7	TXOUT1+
8	TXOUT1-
9	TXOUT0+
10	TXOUT0-
11	GND
12	RXD
13	TXD
14-18	DC IN=10V
19-20	GND
21-30	NC